

F450



THE F450. DESIGNED FOR LIVING LIFE TO THE FULLEST.



THREE-PART SLIDING DOOR

A large sliding door gives easy access to cockpit and saloon, creating a convertible-like sociable space.

WELL-EQUIPPED FLYBRIDGE

Using the large lazarette locker or the optional fridge and BBQ, you make most of the time when cruising beneath the sky.

STUNNING PANORAMIC VIEW

Feel free to look out in any direction from inside. Enjoy endless horizons, coastal landscapes or scenic marinas.

LUXURIOUS AMBIENCE

An extensive choice of high-quality wood finishes and fabric options allows you to create an ambiance to feel like home.

AL-FRESCO DINING FOR SIX

A large table on the fly accommodates up to six people. This area can also be transformed into a generous sunbed.



enjoy the
LIGHT

feel the
SPACE

combine functionality with
DESIGN

All Sealine models are born of the same values: They feature wide interior spaces, an amazing quantity of natural light and outstanding design with German engineering inside. As for these trademarks, the F450 displays the true spirit of Sealine.





THE BEST WAY TO SHARE FREEDOM WITH YOUR LOVED ONES.

For size and sociability, there is nothing quite like the F450. This flybridge cruiser offers unrivalled space for entertainment including berths to sleep for five and an alfresco dining area for six that converts within minutes into a sunbathing place.

EXTERIOR DESIGN





With its L-shaped seating area, the F450 flybridge is ideal to enjoy your time at sea to the most, while an optional fridge and BBQ add to the fun of alfresco dining. It has room for six to dine in comfort around a large dining table.

This area can also be transformed into a spacious sunbed as the seats fold down. It further features such practical additions as a large lazarette locker with ample storage space.



EVERY SINGLE CORNER INVITES YOU TO ENJOY.

Entryway to the saloon is a three-part glass sliding door – an easy access point transforming the cockpit and the saloon of this single-level deck into one large versatile social space. At the helm, twin seats are a pleasant addition to the seating arrangement.





The comfortable I-shaped seating and sofa area can easily be converted into a double berth. There is also easy access to an optional fridge, raise-lower TV and a beautifully crafted table.

A fully equipped open plan galley is located at the port side, an atrium allows light to flow through, while there is a double sink, hob and storage space in abundance, including wine glass and under-floor storage.

Below deck there are two cabins offering five berths as standard. The luxurious master cabin, with its clever use of storage space, gives you plenty of room to unwind. Meanwhile, a separate en-suite shower and toilet facilities create a relaxing spa-like environment. A skylight above the bed illuminates the room and creates a wonderful feeling of space. Cabin windows let in extra light and offer peaceful waterside views.

For additional space and privacy, the F450 offers a midships cabin that can be configured as either three separate berths, a twin or double. This cabin also features a shower and separate toilet with a skylight, while a pullout door creates privacy for the mid cabin when the dayhead is being utilised.





PRINCIPAL DIMENSIONS according to ISO 8666

LOA	13.90 m	45' 8"
Beam	4.48 m	14' 8"
Draught	1.30 m	4' 3"
Height above waterline inc. mast	5.71 m	18' 9"
Height above waterline excl. mast	3.90 m	12' 1"
Headroom	1.95 m	6' 5"
Fuel capacity	1200 l	264 UK gal
Water capacity	450 l	99 UK gal
Displacement approx.	13,052 kg	12.85 t
Max people on board	12	
CE Category	B	

ENGINE OPTIONS

2 x Volvo Penta IPS 500 370 hp, IPS pod drive	38/30 knots*
2 x Volvo Penta IPS 600 435 hp, IPS pod drive	30/32 knots*



FLYBRIDGE



MAIN DECK

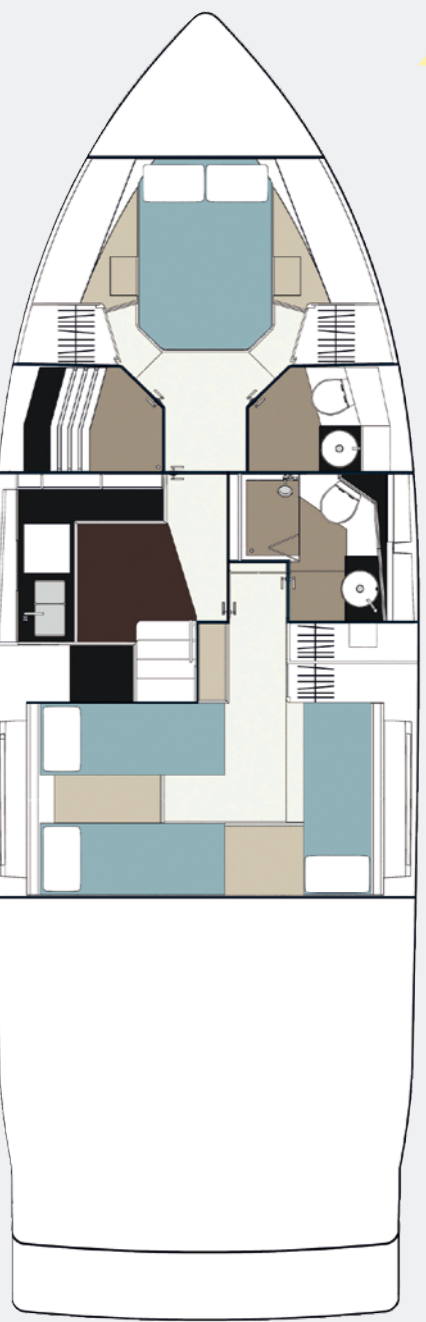

LOWER DECK

TECHNICAL DETAILS

*All performance figures are given in good faith and are intended as an indication. These figures cannot be guaranteed as top speed in particular is affected by the cleanliness of the hull, conditions of the propellers, weight carried and air/sea temperature. SEALINE reserves the right to change specifications in line with the company policy of improvement through research and development. Errors and omissions expected. Please check with your dealer for a full list of inclusions.



IT'S NOT JUST INTERIOR. IT'S THE SETTING OF YOUR EASY-GOING LIFE.

There are countless ways to kit out the interior of your boat. No matter what materials you choose: The quality will always be first-class. Carefully selected fabrics, exquisite floorings and a wide range of well-balanced colours create an ambience you'll enjoy anew each day.





Our fabrics are made of natural materials that show appealing textures and beautiful woven patterns. The leathers are classy, extremely resilient and gentle to touch.

If you have individual requirements about the finishes, you are always welcome to challenge our craftsmen with your special requests. Measuring up to your unique taste is one of Sealine's greatest qualities.

Don't hesitate to create a look that is as individual as you are. The hull and the waterline of your F450 can be painted in almost every colour according to the Alexseal Yacht Coating Selection.

All worktops are made of CORIAN®. This premium surface combines high performance with outstanding aesthetics. It is best known for its seamless appearance and stunning effects of colour and translucency.

Furniture wood comes as standard with satin finish. Some surfaces can be ordered on demand in high gloss finish. The carpets of the cabins are woven of finest wool.

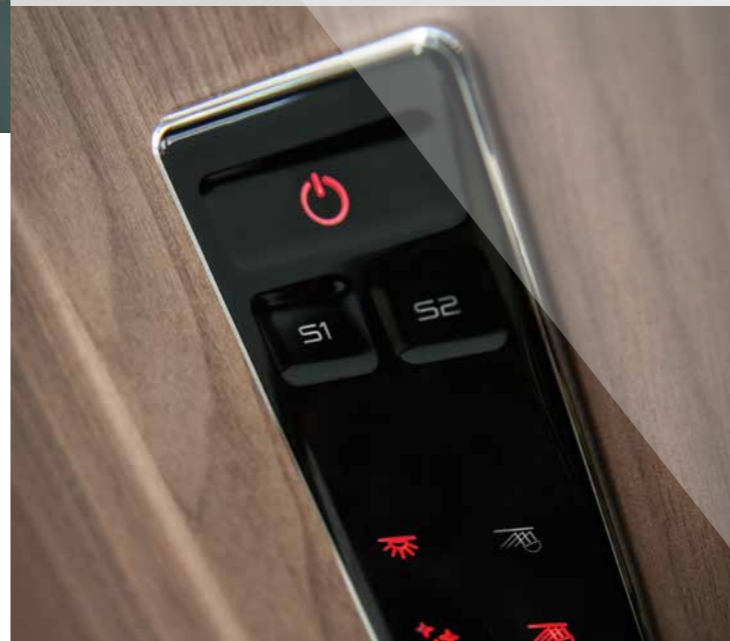



GERMAN PRECISION AND PASSION FOR THE SEA. THAT'S WHAT A SEALINE IS MADE OF.

In 2013, the Sealine brand found a worthy new home on the German Baltic coast. At our shipyard in Greifswald we have perfected the interplay between state-of-the-art manufacturing techniques and skilled employees.

The outstanding people in our team perform their work with enormous experience, a deep understanding of the customer and great dedication.

In addition, we are thrilled to cooperate with international partners like Bill Dixon. Working closely with our in-house personnel, the award-winning designer will create a new range of innovative Sealine models.

Above all, we believe that what holds true for the experienced boater, also holds true for us as boat builders: "Never sail against the sea, sail with it". Beyond the individual skill, there is something which genuinely binds all of us at Sealine: A great passion for the sea.



DROP ANCHOR AT SEALINE

YOUR LOCAL SEALINE DEALER IS LOOKING
FORWARD TO YOUR VISIT.



CRUISE AWAY . SUNBATHE AT SEA
A FLOATING HOME . DAYLIGHT INSIDE
FAVOURITE HAUNTS . WIDE FREEDOM
SHELTERED HOLIDAYS . FAMILY FUN
BUSTLING HARBOURS . STARS ABOVE

F450



www.sealine.com

Sealine Ladebower Chaussee 11 D-17493 Greifswald