

M/Y MAORO LUXURY YACHT CHARTER ON THE ADRIATIC SEA



TECHNICAL DATA:

BUILT: 2005/ REFIT 2019	LENGTH: 21.17 m (69.46ft)	ENGINES: 2 x MAN 1360 hp
GUEST CRUISING: up to 8	BEAM: 5.07 m (16.63 ft)	MAX SPEED: 35 knots
GUEST SLEEPING: up to 6	DRAFT: 1.06 m (3.48 ft)	CRUISING SPEED: 20 knots
CREW: Captain and Stewardess	DISPLACEMENT: 60.000 kg	FUEL CONSUMPTION: 260 L/h
CREW ACCOMMODATION: separate crew quarter	WATER CAPACITY: 1000 L	FUEL CAPACITY: 3200 L

ACCOMODATION: 3 en suite cabins

- Master double bed cabin
- VIP double bed cabin
- Guest twin bed cabin

EQUIPMENT: Air Condition, Generator, BBQ , water maker 170L/h , ice maker, washing/drying machine, microwave, stern and bow large sunbathing area, hydraulic pasarella with RC, bathing platform, suntent , table on the stern , SMART TV LCD TV/DVD in saloon, LCD & DVD in master cabin and VIP cabin, Bose sound touch surround system, Internet Wi Fi 3G/4G

TENDER and WATER SPORTS: Tender: Zodiac 3m with OB 10hp, Jet Ski Sea doo Spark 90h IBR Water skis adult and junior towable by jet ski, Fishing rodes , 2 x Stand Up Paddles, Donut, Snorkeling Equipment

More toys available as extras and ordered in advance ; such as SeaBob F 7, Sea Kayak, wakeboard, bicycle.



M/Y MAORO CRUISING



AT ANCHOR



STERN LOUNGE AREA



THE SALOON



LIFESTYLE MOMENT ONBOARD



MASTER CABIN



SIDE TABLE IN THE MASTER CABIN



BATHROOM



VIP CABIN



ENTRANCE TO THE VIP CABIN



STERN OF THE YACHT



M/Y MAORO -NEW YACHT ON THE CHARTER MARKET

M/Y MAORO is sleek and compact Azimut 68S . It's unique open design allows guests to soak up the sun while relaxing on board. She is a truly remarkable and unique yacht, with flowing lines and a beam of impressive 5.00 meters.

The unique feature of the design of this yacht is the spacious saloon that opens out directly on to an attractive stern deck. When combined with a large section of the saloon roof that can be retracted at the touch of a button to reveal 20 sq meters of sky, this yacht becomes an open sports cruiser.

The crew members are accomodate in separate crew area on the stern of the yacht.



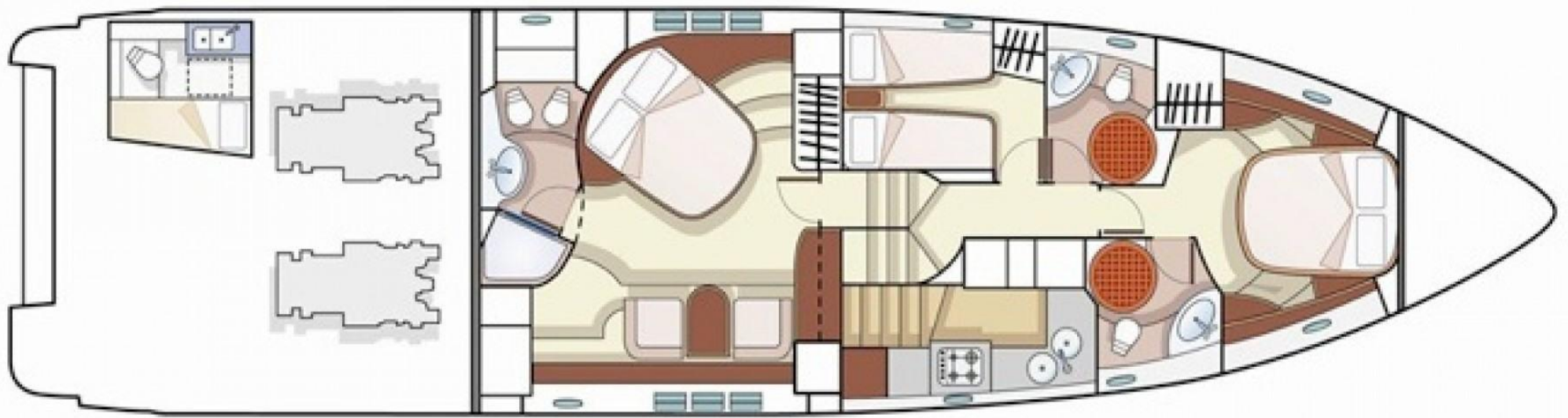

LAYOUT PLAN



HIGHLIGHTS:

- OPEN UNIQUE DESIGN
- SPEED UP TO 35 KNOTS
- SLIDING OPENING ROOF
- LARGE SUN BATHING AREA
- EQUIPPED WITH JET SKI
- IMPRESSIVE MASTER CABIN

WELCOME ON BOARD