



LOA	13.30 m 43'7"
Hull length	13.15 m 43'2"
LWL	12.00 m 39'4"
Beam	4.18 m 13'9"
Draft	2.23 m 7'3" (standard) 1.79 m 5'8" (option)
Displacement	approx. 10.9 t approx. 24,031 lb approx. 10.4 t approx. 22,958 lb
Ballast	approx. 3,200 kg approx. 7,064 lb
Engine	27.9 kW / 38 HP
Fresh water	approx. 325 l
Fuel tank	approx. 230 l
CE Certificate	A (ocean)
Total sail area	approx. 123.50 m ² approx. 1329,00 sq ft
Main sail	approx. 63.00 m ² approx. 678,00 sq ft
Self-tacking jib	approx. 39.00 m ² approx. 420,00 sq ft
Genoa 105%	approx. 60.50 m ² approx. 651,22 sq ft (opt.)
Gennaker	approx. 140.00 m ² approx. 1507,00 sq ft (opt.)
Rig	I: 18.00 m 59'1" J: 4.70 m 15'5" P: 17.70 m 58'1" E: 5.95 m 19'6"
Design	judel / vrolijk & co
Interior	HanseYachts Design

Model year 2010/2011 – valid from August 1st, 2010

STANDARD

OPTIONS

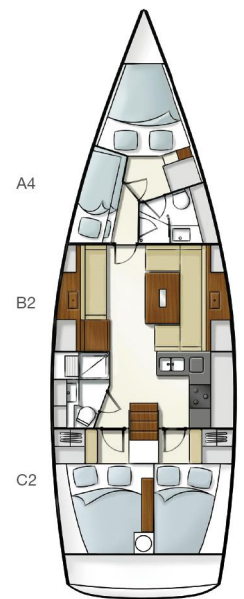
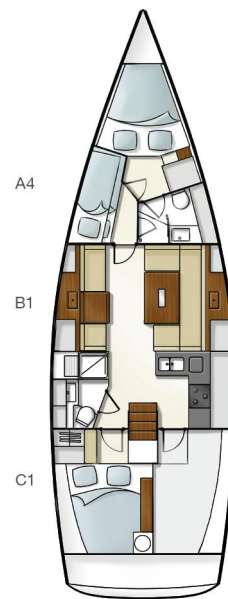
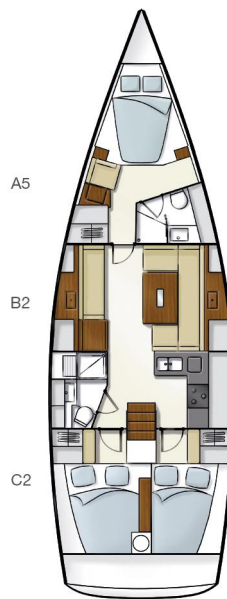
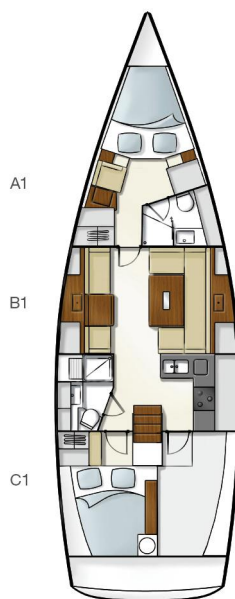
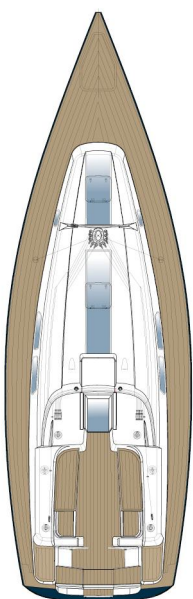

Hull

- White hull
- Dark grey double waterlines
- Options for different hull colours according to Hanse colour selection
- Isophthalic Gelcoat
- Vinylester 1st layer
- Bulk laminate Polyester (orthophtalic or DCPD)
- Sandwich construction (balsa above waterline, foam core below)
- Bulkheads laminated to hull and deck
- GRP strongbacks
- Hull windows

Deck

- White deck
- Isophthalic Gelcoat
- Vinylester 1st layer
- Bulk laminate Polyester (Orthophtalic or DCPD)
- Balsa sandwich
- Non-slip deck surface

Steering System

- Twin wheel steering system
- 2 leather covered steering wheels
- Semi-balanced, profiled rudder with alloy shaft and self-aligning needle bearings
- Emergency tiller

Keel

- Standard: T shape keel draft: 2.23 m / 7'3"
- Option: Shallow draft 1.79 m / 5'9"
- Stainless steel keel bolts

Deck Equipment

- Self-draining anchor locker with lockable hatch
- Self-draining cockpit with large lockable storage
- 3 opening flush hatches
- 4 acrylic opening glass windows
- 6 opening opening portholes
- 4 mooring cleats
- 2 self-tailing halyard winches 46 AST
- 2 self-tailing genoa winches 46 AST
- Halyards lead aft to cockpit
- Control lines covered on the coachroof
- 2 winch handles
- Shower on aft deck
- 10 halyard stoppers
- Midboom sheeting with 2 stand-up blocks
- Split pulpit
- Pushpit with ensign staff socket
- Sliding hatch garage
- Sliding hatch
- Drop board
- Double stainless steel safety rail
- Handrails
- Teak on cockpit seats
- Teak on cockpit bottom option
- Teak partly on coach roof
- Swimming ladder

Technical System**Plumbing System / Fresh Water****Tank**

- Fresh water capacity approx. 325 l
- Water infill on deck

Hot water

- Warm water heater, running from engine or immersion heater 230 V

Pumps

- Electrical pressurised water system

Faucets

- Faucets in galley and head

Draining Pumps**Bilge pumps**

- 1 manual bilge pump
- 1 electric bilge pump

Toilet / Head

- Holding tank
- 2 manual marine toilets
- 2 heavy duty shower drain pumps
- Sea and deck discharge

Engine

- Volvo D2-40 27,9 kW / 38 HP, diesel engine
- Saildrive
- Fresh water cooling
- 2-blade fixed propeller
- Fuel tank, approx. 230 l
- Fuel infi II on deck
- Seawater strainer
- Fuel filter / Water separator
- Revolution counter
- Engine hour meter
- Engine room sound insulated

Electrics

- 12 V and 230 V electrical circuits
- Shore power 230 V incl. differential breaker

Battery charger

- Battery charger 12 V / 30 Amp.

Batteries

- Main battery switch
- 1 Engine battery: 12 V / 80 Ah AGM
- 1 Service battery: 12 V / 80 Ah AGM

Electric control panel 12 V

- Onboard electrics
- Socket 12 V
- Voltmeter
- Water / Fuel gauges

Electric panel 110 V / 230 V

- Differential breaker
- Socket 230 V
- Separate switch for warm water heater

Interior lighting

- in fwd. cabin
- in aft cabin
- in saloon
- in galley
- in head
- in storage room

Navigation lights, all LED

- Steaming light
- Bow light
- Stern light
- Anchor light

Navigation instruments

- Illuminated compass
- Depth sounder
- Log

Galley

- Solid surface stone optic- cream
- Double stainless steel sink
- 2-burner LPG gas stove with oven, gimbaled
- Gas system and self draining LPG bottle storage in cockpit
- Lockers and drawers
- Extra large 12 V fridge of approx. 130 l, top and front loader with light
- Waste bin

Interior Accommodation

- High quality marine plywood, mahogany veneer, satin varnish
- Option: Beech veneer, satin varnish
- Maple style floorboards
- Optional: Cherry style floorboards
- White bulkheads
- Wooden door frames
- Wood / Sandwich doors

Upholstery

- According to Hanse colour selection

Forward cabin

- Separated from saloon by a door
- Large double berth, queen size
- Comfortable seat
- Combined locker
- Shelves above berth
- Toilet and shower room with manual toilet with holding tank and sea and deck discharge
- Options according to Hanse Individual Cabin Concept

Aft cabin

- Separated from saloon by a door
- Large double berth
- Combined locker
- 1 opening port hole to cockpit

Saloon

- Companionway steps
- U-shaped settee area on starboard and 2 seater sofa on port side
- Saloon table
- Bar locker
- Lockers and shelves

Navigation area

- Separated navigation area on port side
- Chart table with storage
- Electric switch panel

Head / Shower

- Large head with separate shower stall
- Marine toilet
- Holding tank
- Sea and deck discharge
- Sink
- Electrical drain pump
- Mirror
- Locker & shelves
- Opening acrylic glass window

Rigg and Sails

- 9/10-rig, tapered masttop
- Two spreader anodised aluminium mast and boom
- Under deck furling system for jib
- Hanse single line reefing system (cockpit handling)
- Rod kicker
- Stainless steel standing rigging
- Backstay adjuster
- Main and jib halyard lead aft to cockpit
- Main and jib sheets
- Main sail fully battened with 2 reefs
- Self-tacking jib with traveller